



Part No. 906800, 906800DHL

Model CF325XPRO24
Cordless XPro
30° Framing Nailer



CLEANING PROCEDURE

www.paslode.com

Literature Part Number: 906868-1

This procedure provides a simple but effective way to clean your Paslode Cordless Framing Nailer and maintain reliable operation. Regular cleaning and lubrication will also extend part life and provide maximum nail driving power.

Only one tool is necessary to disassemble the Paslode Cordless Framing Nailer in preparation for cleaning: the 5/32" hex key wrench provided with the Paslode Cordless Framing Nailer.

Paslode recommends that an aerosol "Cleaner/Degreaser" or Paslode® Cordless Tool Cleaner (Part No. 219348), (Canada use Part No. 219086) be used for cleaning.

This cleaner is available through your local Paslode Dealer.

If a different type of cleaner is selected, make sure that it will not damage plastic, rubber or electronic components. Chemical damage to these materials or components

may result in the tool being made inoperable. Although "safety" cleaners generally provide reduced risk of fire and are more stable than other cleaners, they cannot be handled carelessly. Always follow the manufacturer's instructions and never spray cleaner on the Paslode Cordless Framing Nailer, unless the tool has been allowed to cool down.

To begin, you will need the following items:

1. Tool
2. Cordless Tool Cleaner/ Degreaser
3. Paslode Cordless Lubricating Oil



DANGER

Remove all fasteners, fuel, and battery prior to servicing the tool.

Handle-Magazine Removal

Step 1

Use the 5/32" Hex Key Wrench (# 401331) to remove the **Handle-Magazine Assembly** by loosening the two #10-24 x 1-1/8" long Socket Head Cap screws on the nose piece of the tool. You may have to adjust the two (2) orange probe-release buttons on the sides to allow the screws to fully disengage. The **Handle-Magazine Assembly** is now ready to be pivoted away from the Motor Assembly in Step 8.

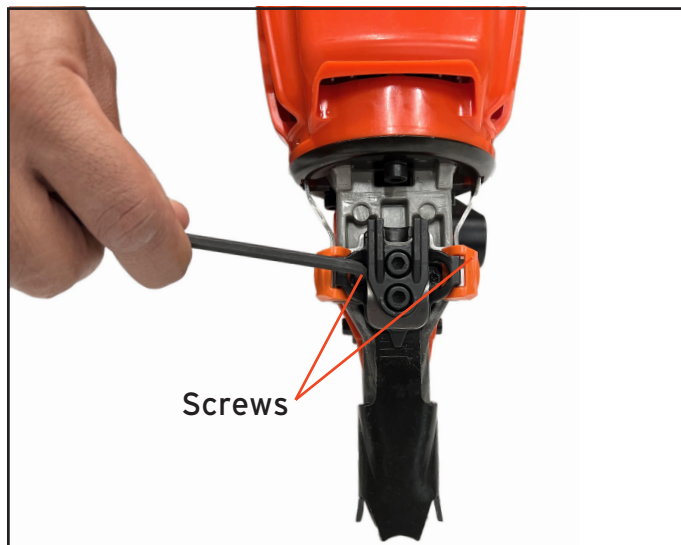

Step 2

Remove the grille and air filter. Clean them in soapy water or with Paslode Cordless Tool Cleaner/Degreaser and allow to dry before re-assembling.



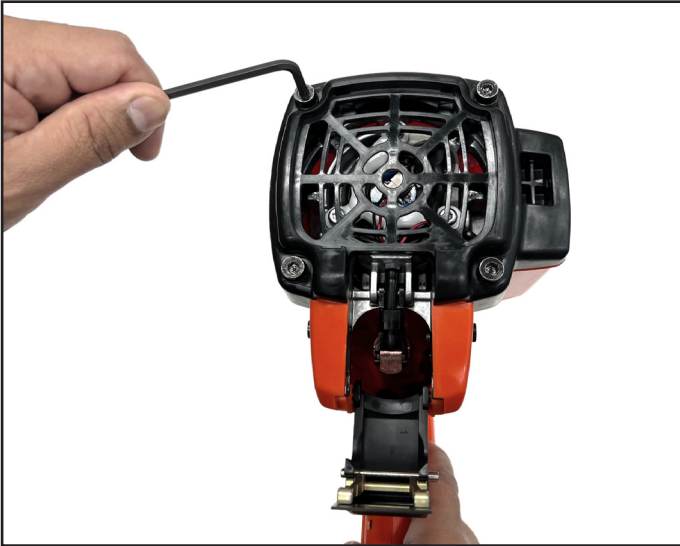

Step 3

Remove the cap by unscrewing the four #10-24 Socket Head Cap Screws.



WARNING

Never operate the Paslode Cordless Framing Nailer unless all four Socket Head Cap Screws are firmly tightened on the cylinder head. Failure to do this could result in tool damage, fire and personal injury.

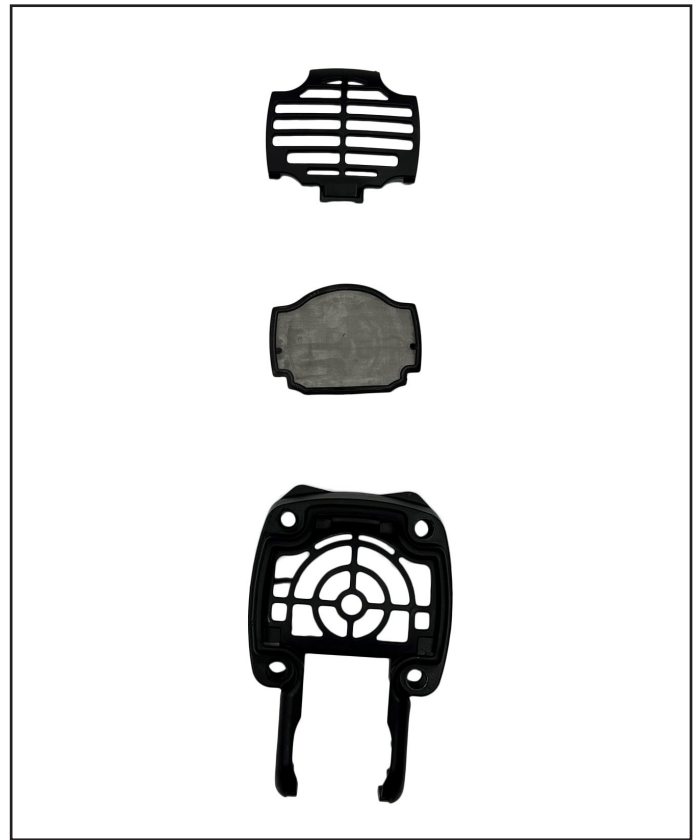

Set the grill, filter, and cap aside.

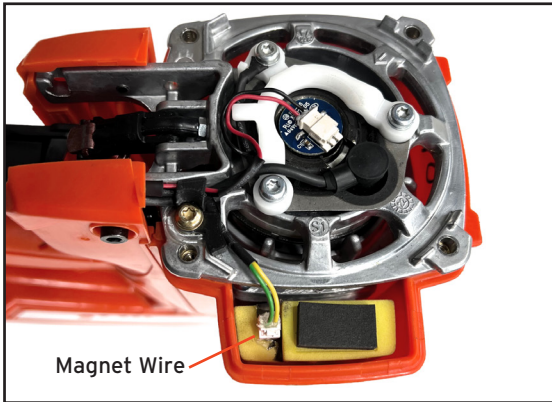

Step 4

Disconnect the magnet wire from the magnet cartridge by depressing the locking tab on the connector, and slide the magnet cartridge out. Avoid pulling on the wire or the foam pad. **Wipe the face of the magnet with a lint-free rag.**

Step 5

Carefully pivot the **Handle-Magazine Assembly** away from the **Motor Assembly** and gently pull the two assemblies apart. **CAUTION:** Use care to ensure that the fan does not scratch the combustion chamber. Also be careful when setting the Handle-Magazine Assembly down so that you do not damage the two (2) magnet wires and connector, the fan blades or bend the fan motor shaft.

You have now separated the tool into two major assemblies, allowing access to the areas that require periodic cleaning and lubrication.



DANGER

Never operate the Paslode Cordless tool unless all four Socket Head Cap Screws are firmly tightened on the cylinder head. Failure to do this could result in tool damage, fire and personal injury.



Cylinder Head

Step 1

Spray the **Cylinder Head** (make sure not to miss the spark plug and surrounding area) with cleaner/degreaser. Allow the dirt and debris to drip off.

DO NOT LET OVER-SPRAY OR DIRTY CLEANER/DEGREASER RUN INTO THE HANDLE.



Step 2

Using a clean, lint-free rag, wipe off any remaining cleaner or dirt. Make sure the **Seal Rings** and **Spark Plug** are completely clean and clear of debris. Repeat Step 1 to remove any heavy deposits or remaining residue.

Step 3

Thoroughly lubricate the **Seal Rings** with **Paslode Cordless Lubricating Oil**, part #401482. Make sure oil is applied evenly around entire **Seal Ring**.

Set the **Handle/Cylinder Head Assembly** aside. After lubricating and before reassembly, ensure the position of the gaps of the two (2) seal rings are at 180 degrees from each other, (facing away from each other).

Note:

Paslode Cordless Lubricating Oil is specially formulated for use in the **Paslode Cordless Framing Nailer**. The use of other types of lubricants may cause rapid build-up of combustion residue or result in premature part failure.



Step 4

Push the **Piston Assembly** to the "down" position using the handle portion of a screwdriver or a clean piece of wood.



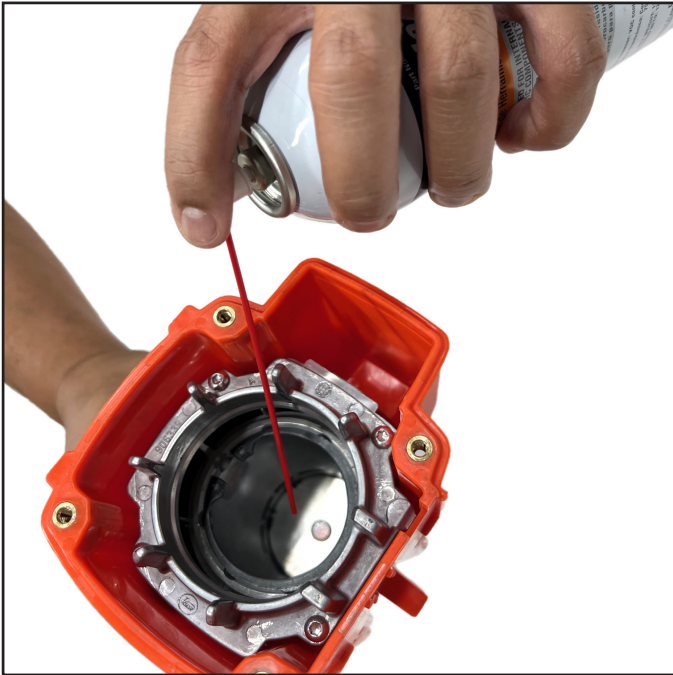

Step 5

Spray a liberal amount of Cordless Tool Cleaner into the inside of **Sleeve and Combustion Chamber**. Invert **Motor Assembly**, and let excess cleaner and dirt drain out.



Step 6

Using a clean area of a lint-free rag, wipe off any remaining cleaner or dirt. Repeat Step 5 to remove any heavy deposits or remaining residue.

Motor Assembly

Step 7

With open end of the **Motor Assembly** facing up, squeeze 4-5 drops of oil onto the inside of the **Sleeve wall** (Area "A") and 5-6 drops onto lower lip of **Combustion Chamber** (Area "B"). Rotate **Motor Assembly** while oiling to ensure oil is evenly distributed around **Sleeve** and combustion chamber lip. See Tool Cutaway Illustration.



Step 8

Hold **Motor Assembly** upright, ensuring that the two (2) loosened nose screws do not interfere with the movement of the work contact element. Depress the work contact element and reach into the housing magnet cavity to **wipe the magnet plate** with a lint-free rag. After wiping the plate, push down and release several times to allow oil on lower lip of **Combustion Chamber** to be evenly distributed.



Step 9

Manually push the **Driver Blade** up and down to distribute the oil in the **Sleeve** evenly.

Before reassembly, manually push the driver blade back up to the top.



Step 10

Tilt the **Motor Assembly** upright, and apply 3-4 drops of **Paslode Cordless Lubricating Oil** evenly spaced around the top of the **Combustion Chamber** (Area "C"). Spread the oil using your fingertip.

Step 11

Reassemble the **Paslode Cordless Framing Nailer** following disassembly Steps 4-8, in **Reverse** order.



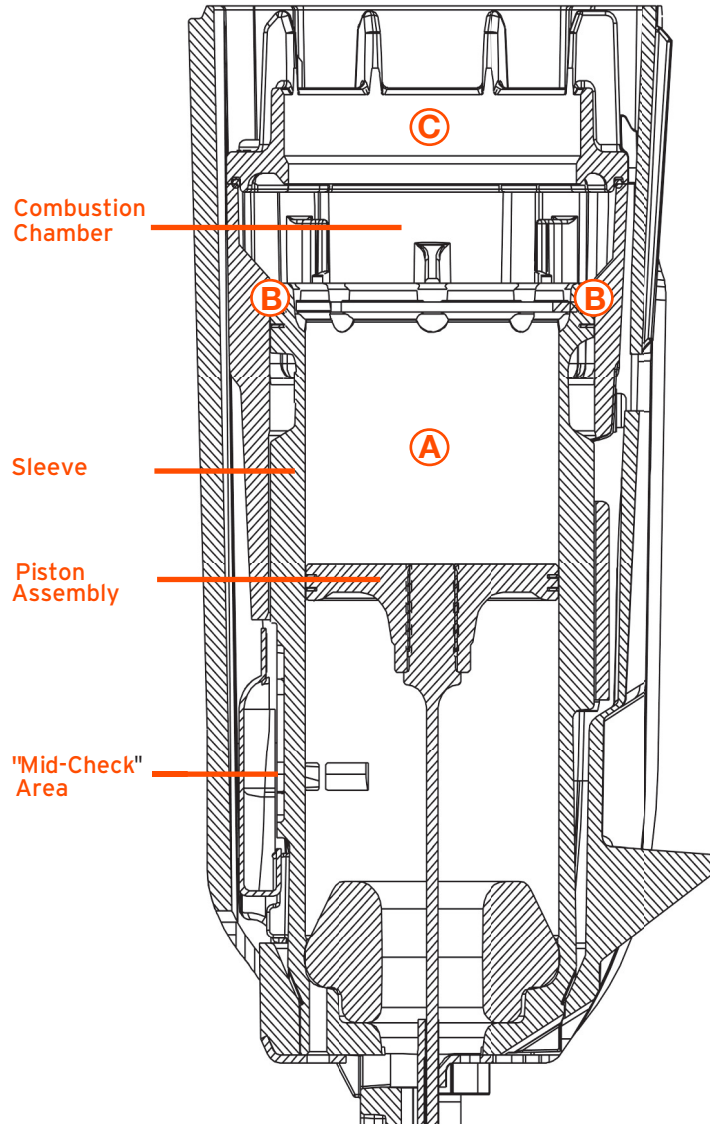

Tool Cutaway Illustration

Motor Assembly



DANGER

Do not attempt to operate the tool unless the cap assembly is securely attached to the housing. Operating the Paslode Cordless tool with a loose or missing cap assembly can result in the escape of burning gases, tool damage, and injury to tool user and property.

NOTE

After the tool is completely reassembled and all screws are tightened, test the tool for proper operation. Some smoke may be noticeable from the exhaust ports on the first few cycles as excess oil is burned off. Consult the operating manual for instructions if the tool malfunctions.

30° Cordless Framing Nailer Cleaning Procedure

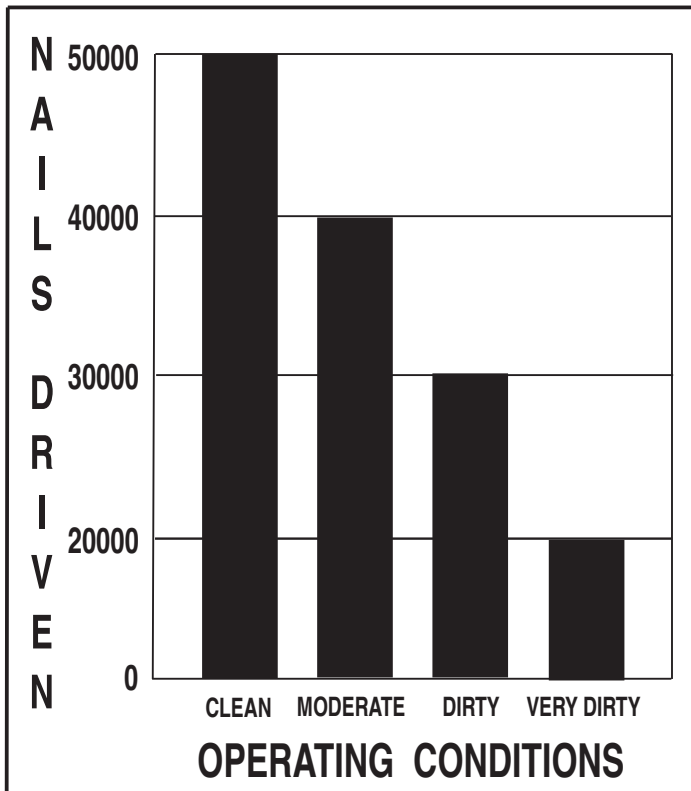

The maintenance interval for cleaning the **Paslode Cordless Framing Nailer** will vary depending upon the number of nails driven, and the operating conditions under which the tool is used. When the **Paslode Cordless Framing Nailer** is used in a dirty environment or at high nailing rates for extended periods, cleaning should be performed at shorter intervals.

Paslode has developed this chart as a guideline to assist you in establishing the proper cleaning schedule for the type of use the tool is getting. If you find that the suggested cleaning interval is allowing the tool to become excessively dirty between cleanings, reduce the interval to the next shorter frequency. If it is apparent that the **Paslode Cordless Framing Nailer** is not in need of cleaning at the scheduled time, increase the interval to the next longer period.

If you have any questions regarding this chart or any of the instructions in this cleaning procedure, contact your Paslode representative for assistance.

30° Cordless Framing Nailer Cleaning Procedure

Part No. 906800; 906800DHL

Model CF325XPRO24

**For Technical Support call:
1-800-222-6990
Go to: paslode.com
to find Parts and Service Centers**



An Illinois Tool Works Company
155 Harlem Avenue
Glenview, IL 60025
www.paslode.com